

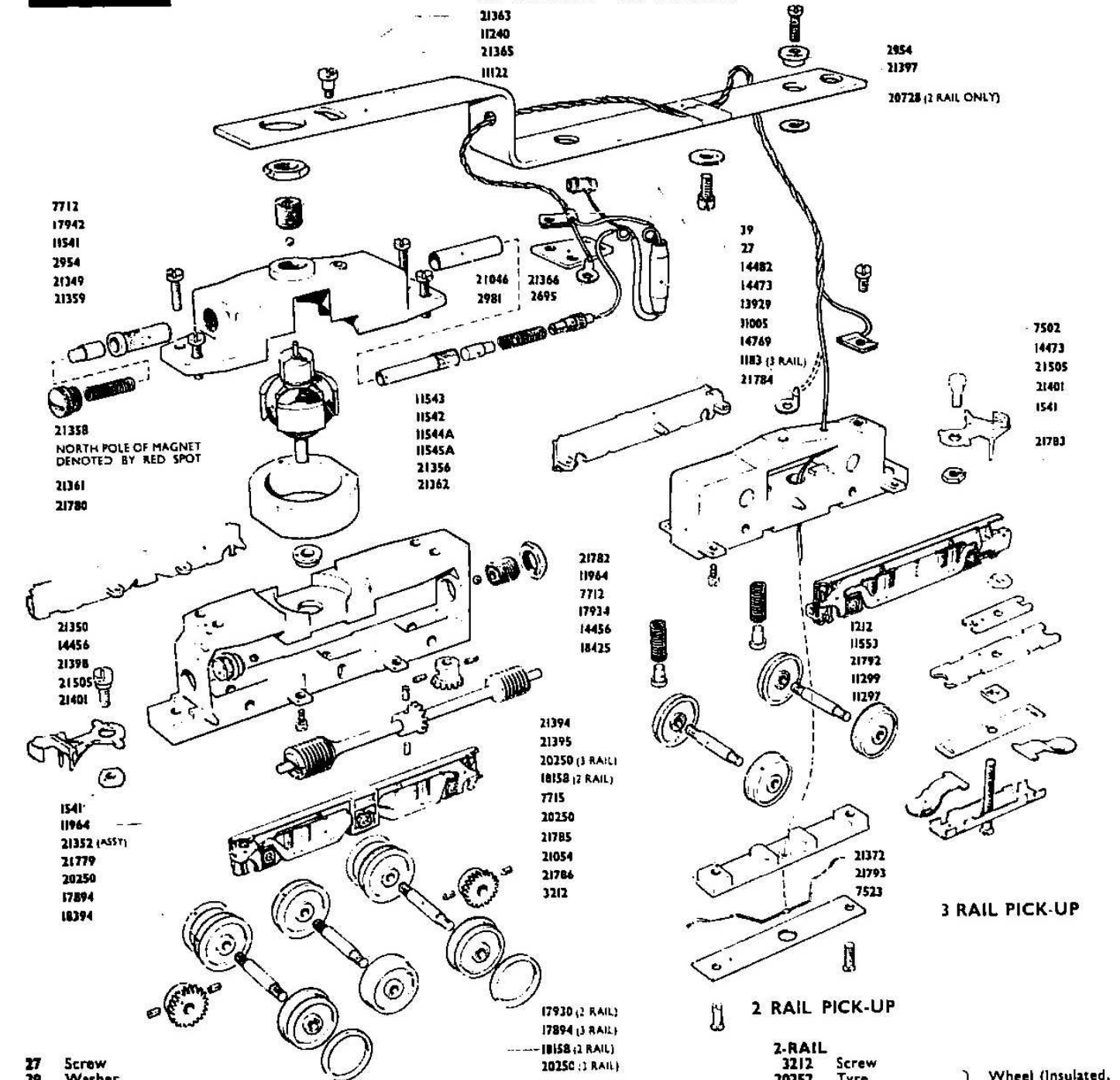

CO-BO DIESEL ELECTRIC LOCOMOTIVE 2-RAIL AND 3-RAIL

No. 2233 2-RAIL — No. 3233 3-RAIL



- 27 Screw
- 39 Washer
- 1541 Nut
- 2695 Soldering Tag
- 2954 Screw
- 2981 Screw
- 7502 Screw
- 7712 Locking Nut
- 7715 Axle
- 11005 P.V.C. Sleeve
- 11545A Plug (with boss)
- 13929 Choke
- 14473 Clamp for Wire
- 14482 Condenser
- 14769 Connecting Wire
- 21366 Insulating Support
- 11122 Connecting Wire
- 11240 Self Adhesive Tape
- 11541 Ball Bearing
- 11542 Brush Holder
- 11543 Brush
- 11544A Spring
- 11964 Screw
- 14456 Ball Bearing
- 17934 Adjustable Bearing Housing Assembly
- 17942 Adjustable Bearing Housing Assembly
- 20249 Grub Screw
- 21355 Mitre Gear
- 20249 Grub Screw
- 21364 Worm Wheel

Suppression Assembly
Job No. 18426

- 20250 Wheel
- 20251 Wheel (with tyre groove)
- 20252 Tyre
- 21046 Insulating Sleeve
- 21349 Top Casting
- 21350 Bottom Casting
- 21352 Layshaft Assembly
- 21356 Armature Shaft Assembly
- 21358 Plug
- 21359 Brush Holder (with flange)
- 21361 Bottom Bearing
- 21362 Ring Magnet
- 21363 Screw
- 21365 Mounting Plate
- 21394 Spring
- 21395 Plunger
- 21397 Insulating Bush
- 21398 Fixed Bearing Assembly
- 21401 Coupling
- 21505 Screw
- 21779 Sideframe (L.H.)
- 21780 Sideframe (R.H.)
- 21782 Casting for Bogie
- 21783 Sideframe (L.H.)
- 21784 Sideframe (R.H.)

Wheel (with tyre) Assembly
Job No. 17894

2-RAIL

- 3212 Screw
- 20252 Tyre
- 20690 Insulating Bush
- 20703 Wheel (with tyre groove insulated)
- 20702 Wheel (insulated)
- 20690 Insulating Bush
- 20728 Washer
- 21054 Wire Collector
- 21785 Base for Collector
- 21786 Cover for Collector Base

Wheel (Insulated, with Tyre) Assembly
Job No. 17930
Wheel (Insulated) Assembly
Job No. 18158

ASSEMBLIES

- 21771 Housing Assembly
- 21778 Motor Bogie Assembly
- 21781 Rear Bogie Assembly

3-RAIL

- 1183 Soldering Tag
- 1212 Nut
- 7523 Screw
- 11297 Collector Shoe Spring
- 11299 Distance Piece
- 11553 Insulator (Screw)
- 21372 Collector Shoe
- 21792 Insulator
- 21793 Collector Shoe Holder

ASSEMBLIES

- 18483 Housing Assembly
- 21790 Motor Bogie Assembly
- 21791 Rear

3 RAIL PICK-UP

2 RAIL PICK-UP